

A.M.01 Banheiro Fem.
Escala: 1:25

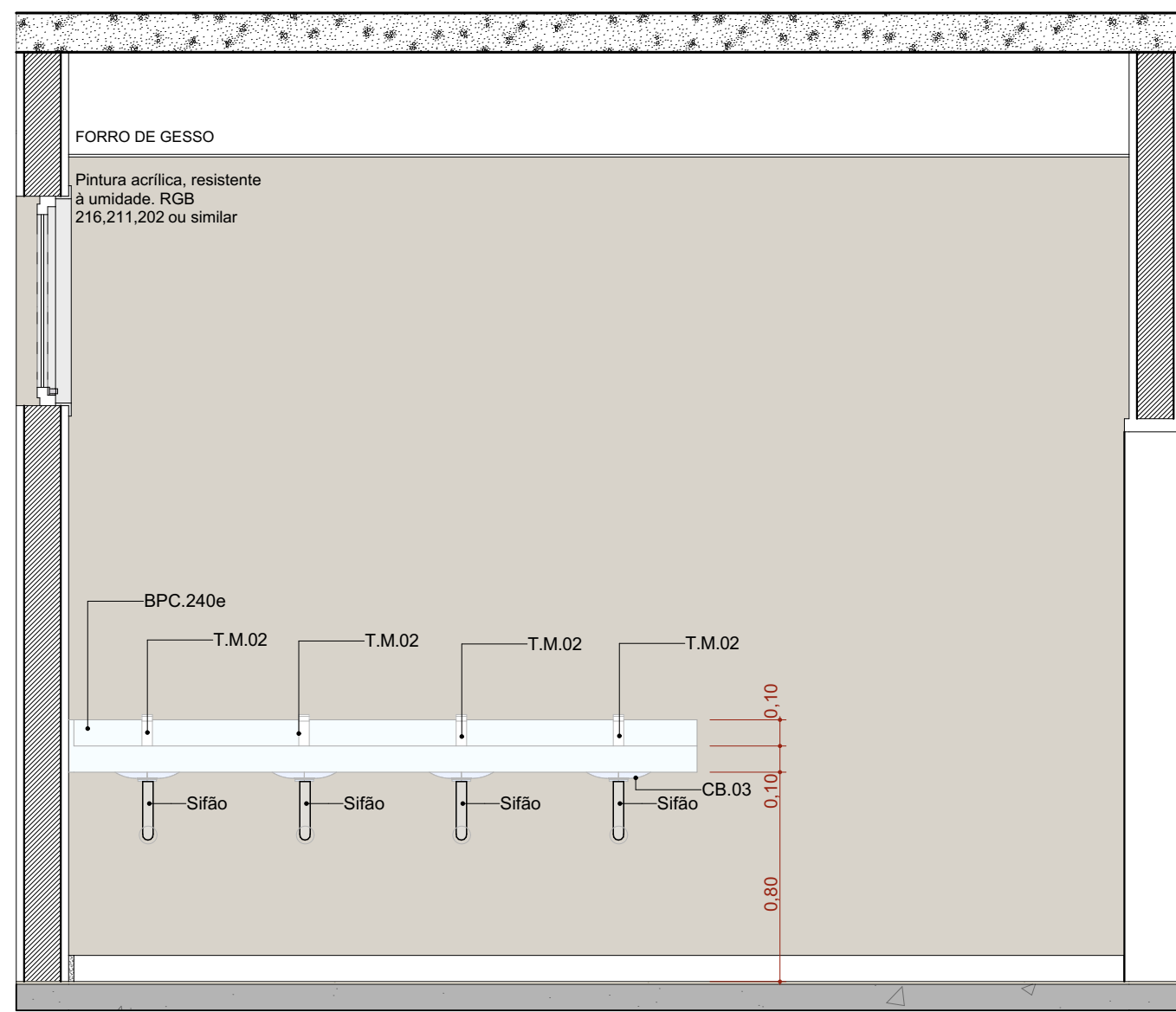

A.M.01 VISTA 01
Escala: 1:25

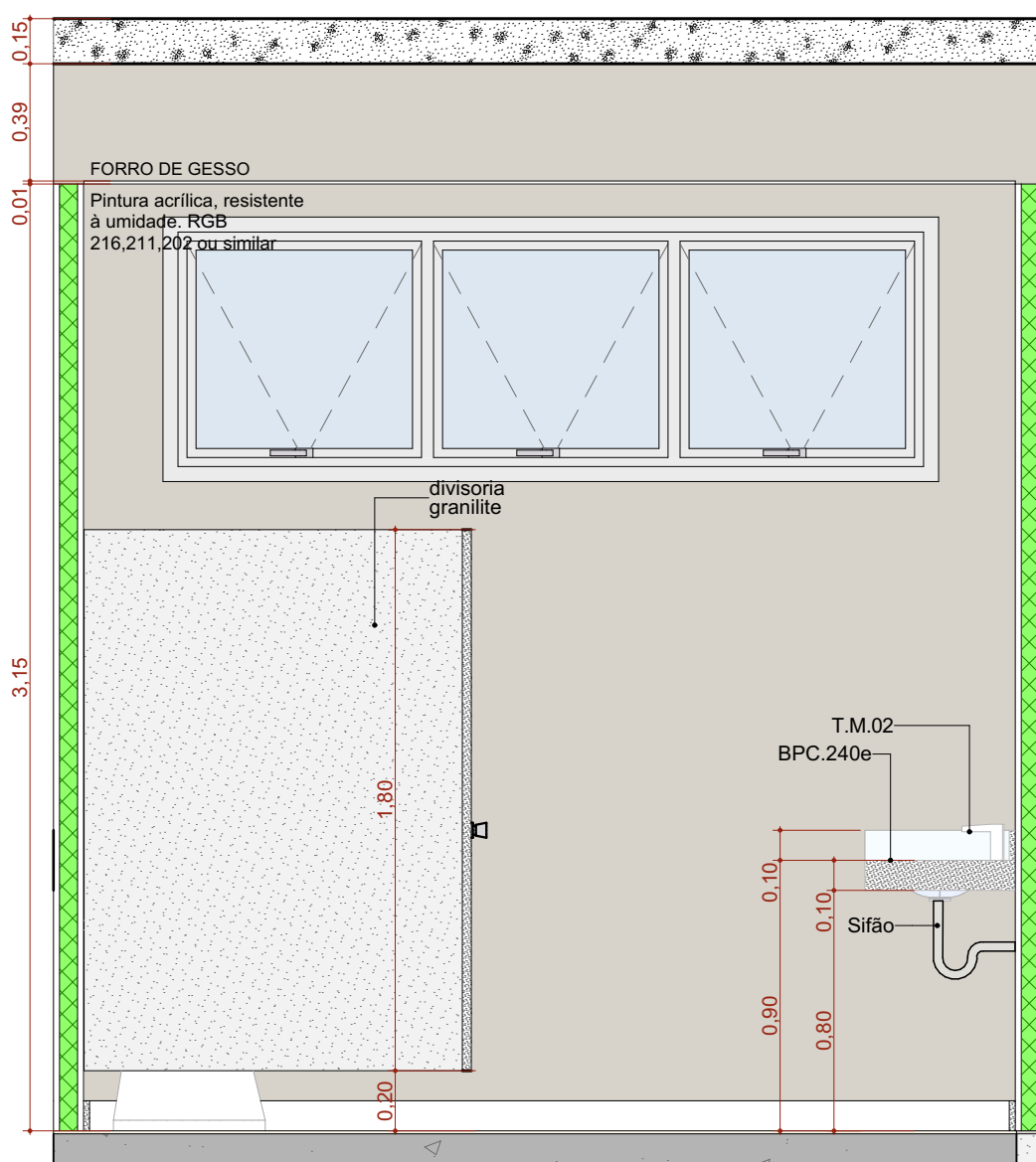

A.M.01 VISTA 02
Escala: 1:25

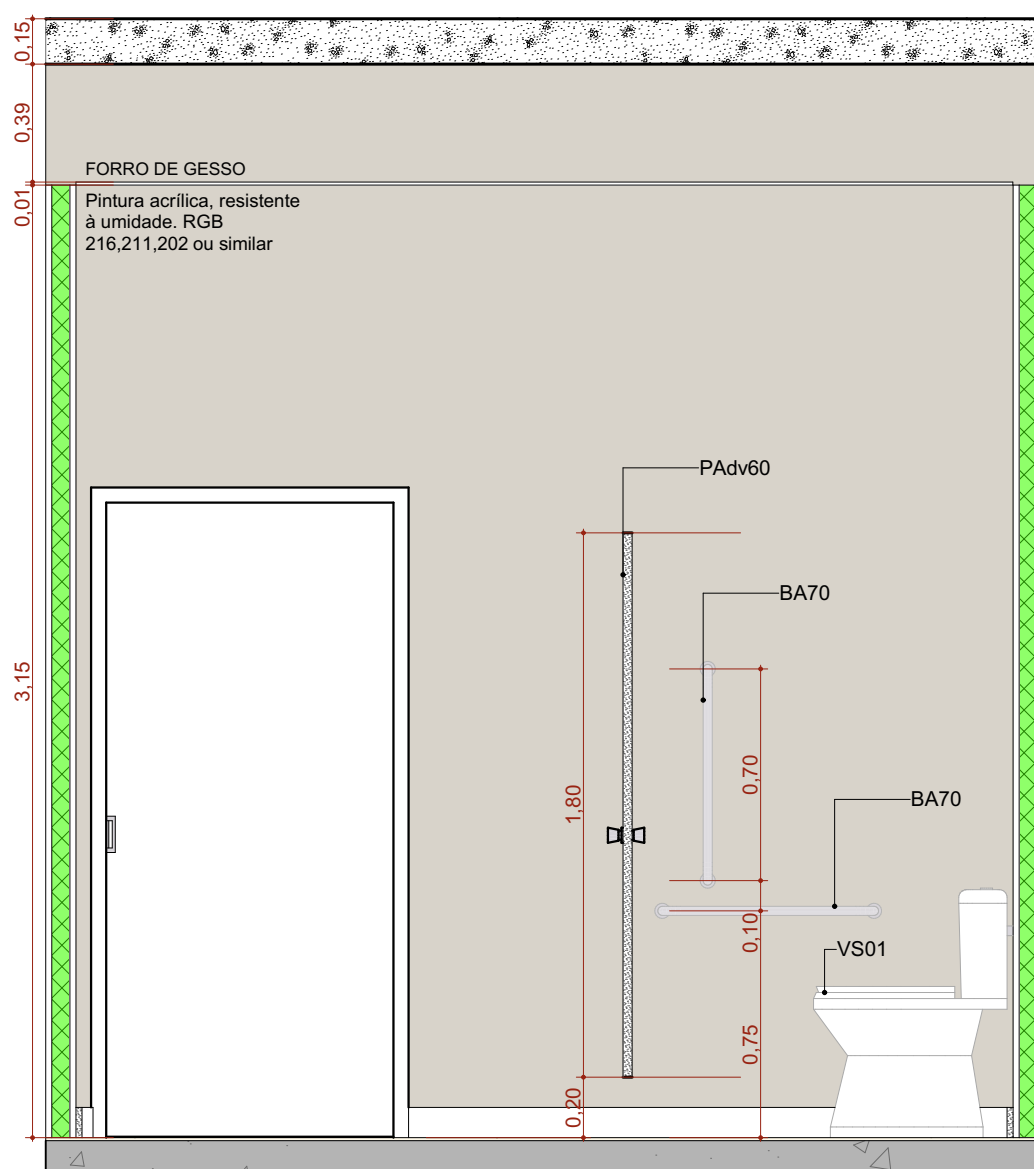

A.M.01 VISTA 03
Escala: 1:25

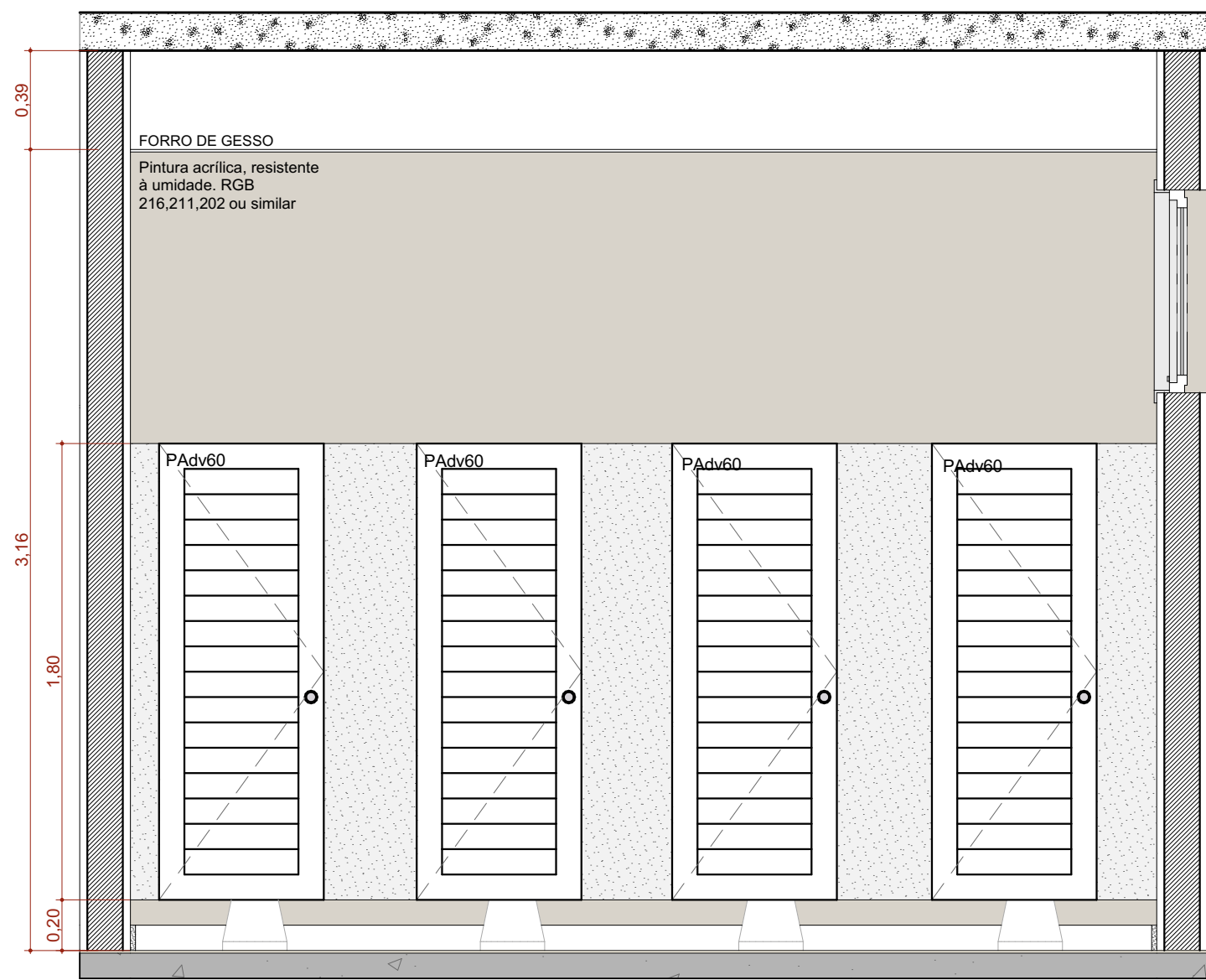

A.M.01 VISTA 04
Escala: 1:25

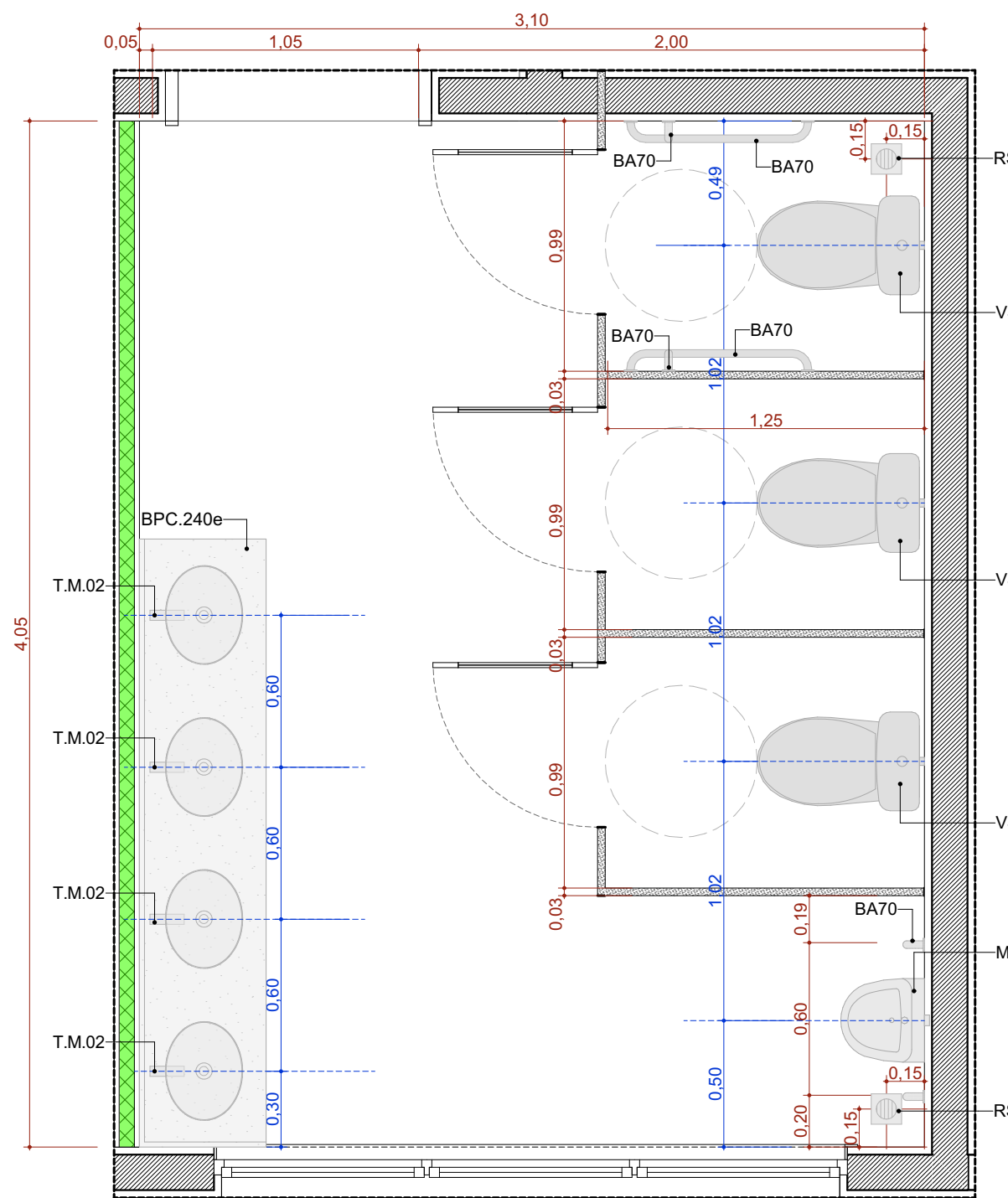

A.M.02 Banheiro Masc.
Escala: 1:25

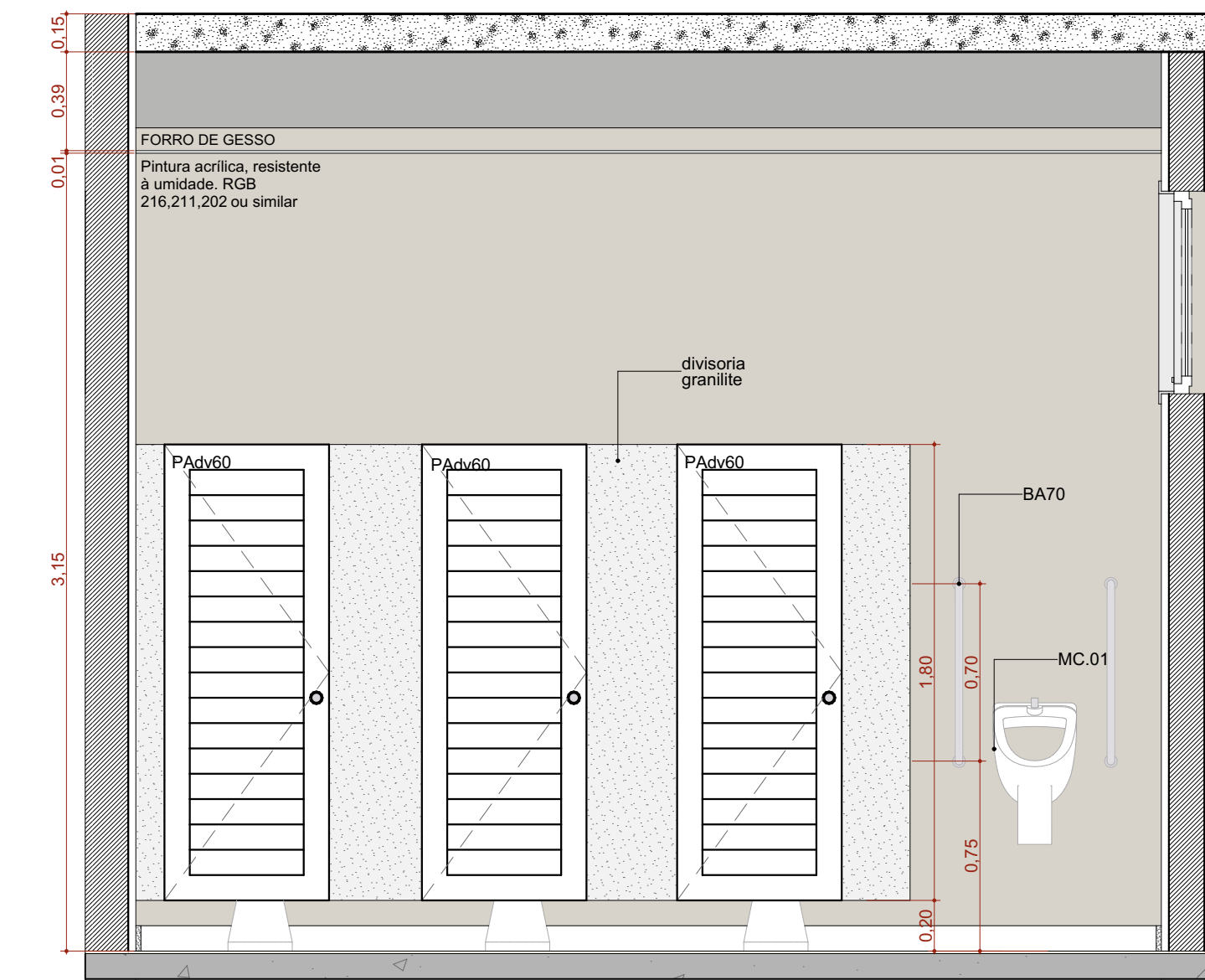

A.M.02 VISTA 01
Escala: 1:25

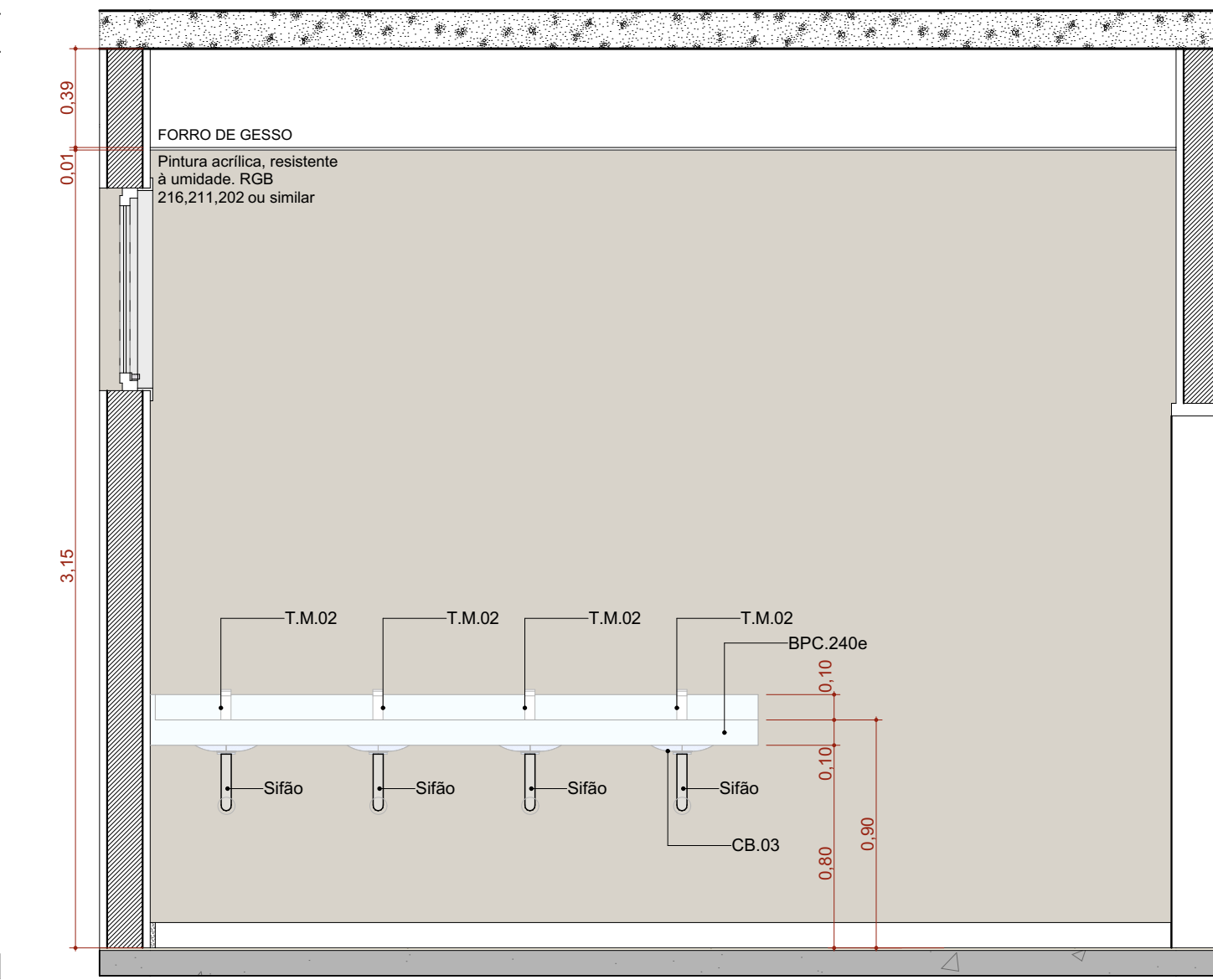

A.M.02 VISTA 02
Escala: 1:25

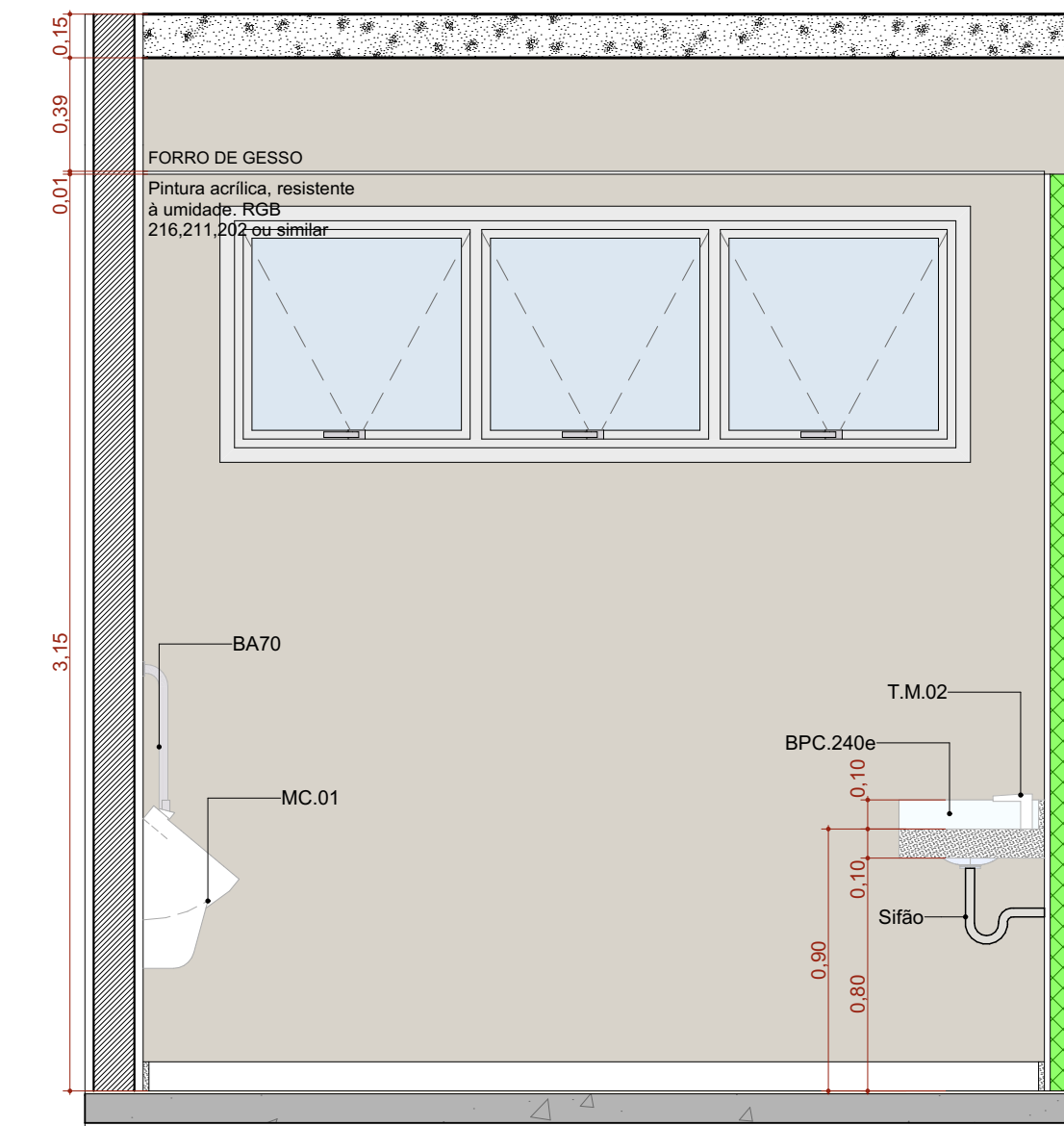

A.M.02 VISTA 03
Escala: 1:25

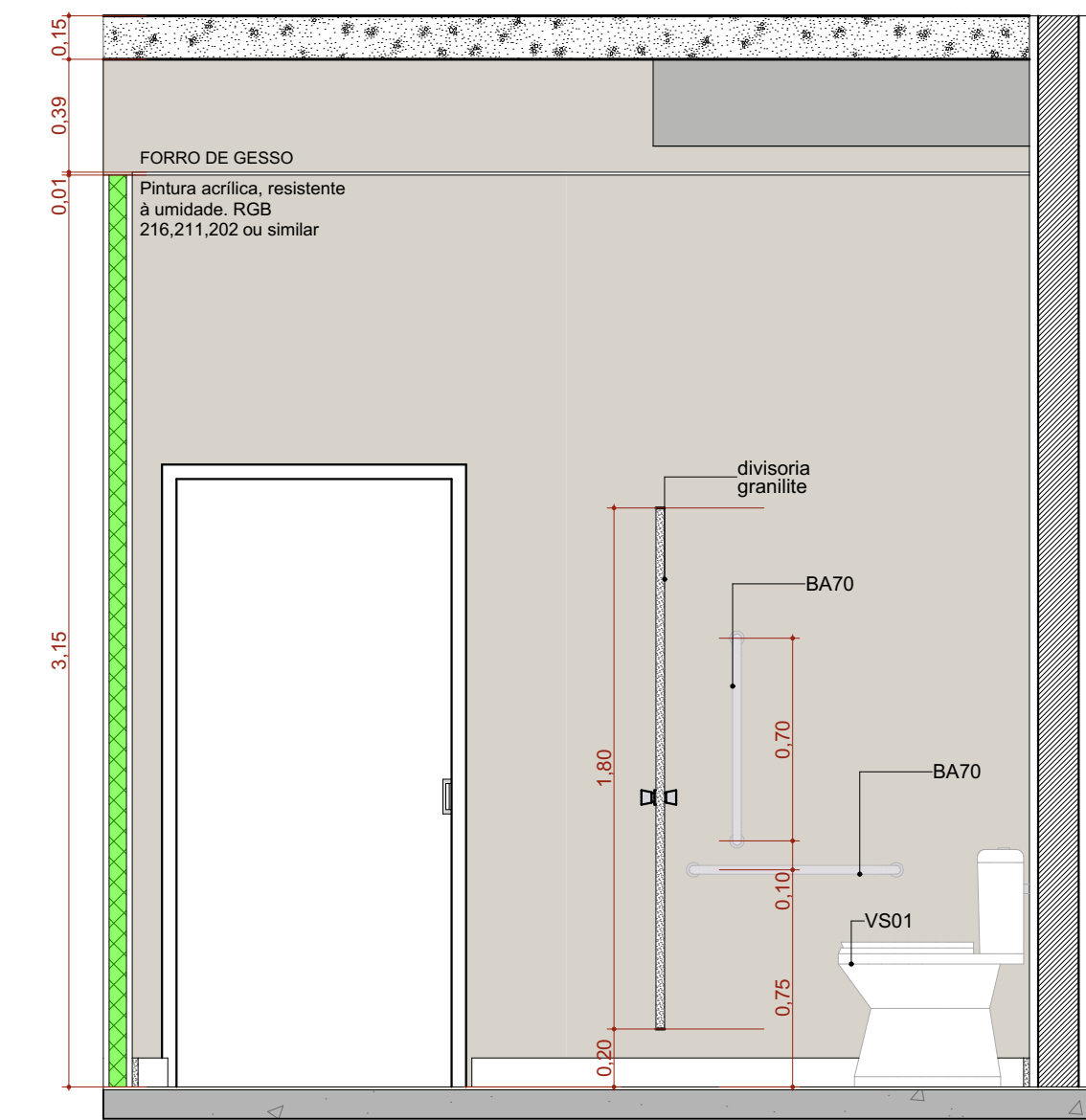

A.M.02 VISTA 04
Escala: 1:25

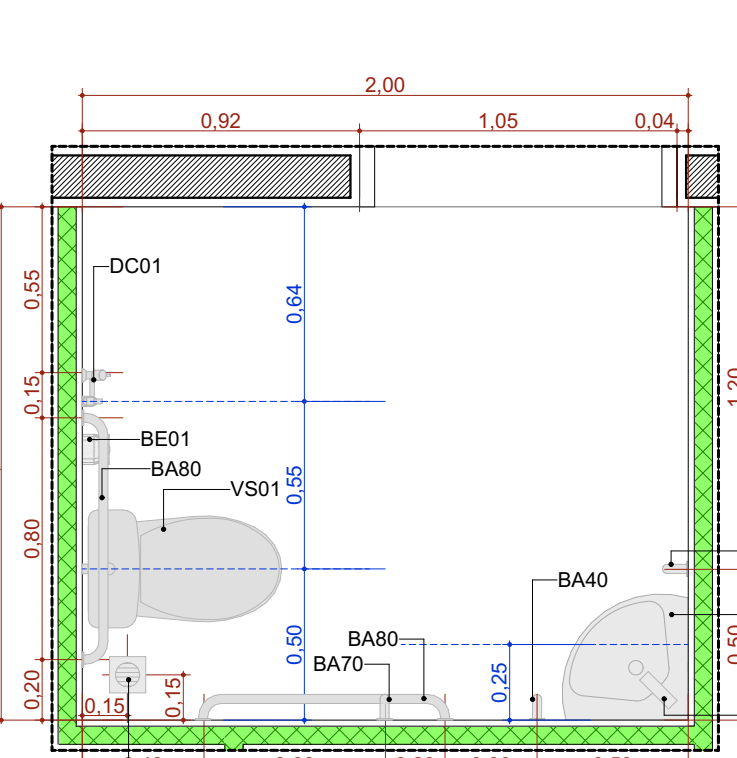

A.M.03 Sanit. PCD
Escala: 1:25

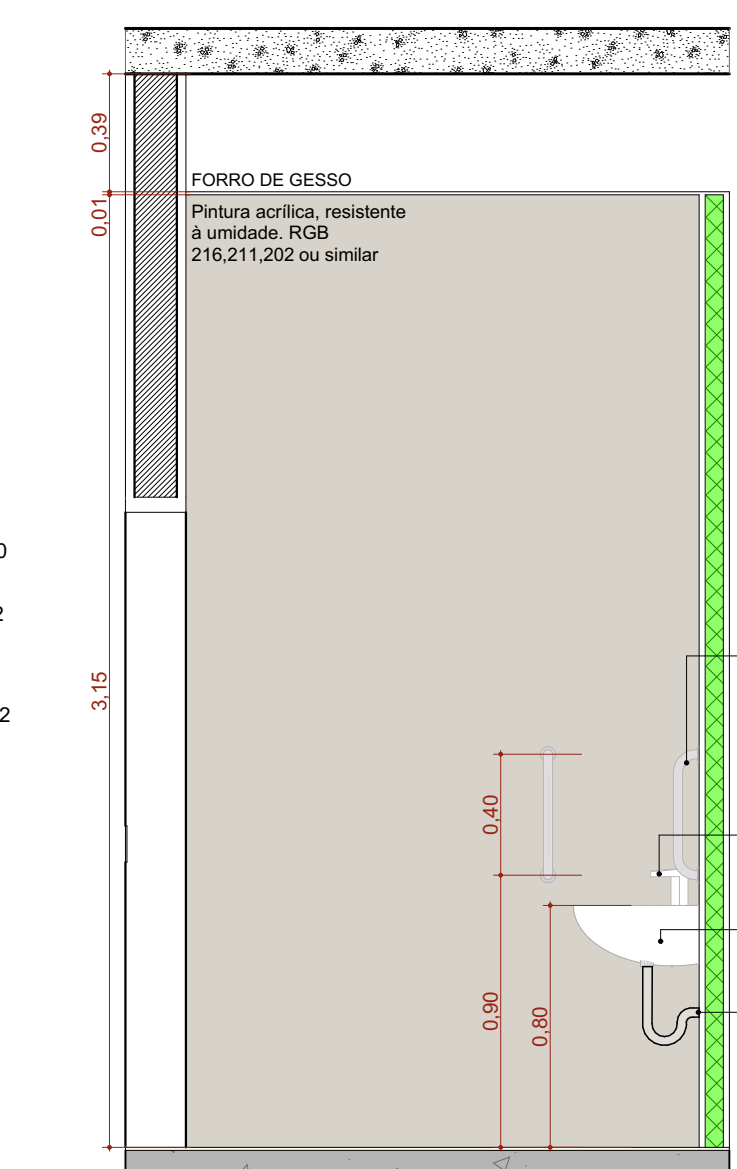

A.M.03 VISTA 01
Escala: 1:25

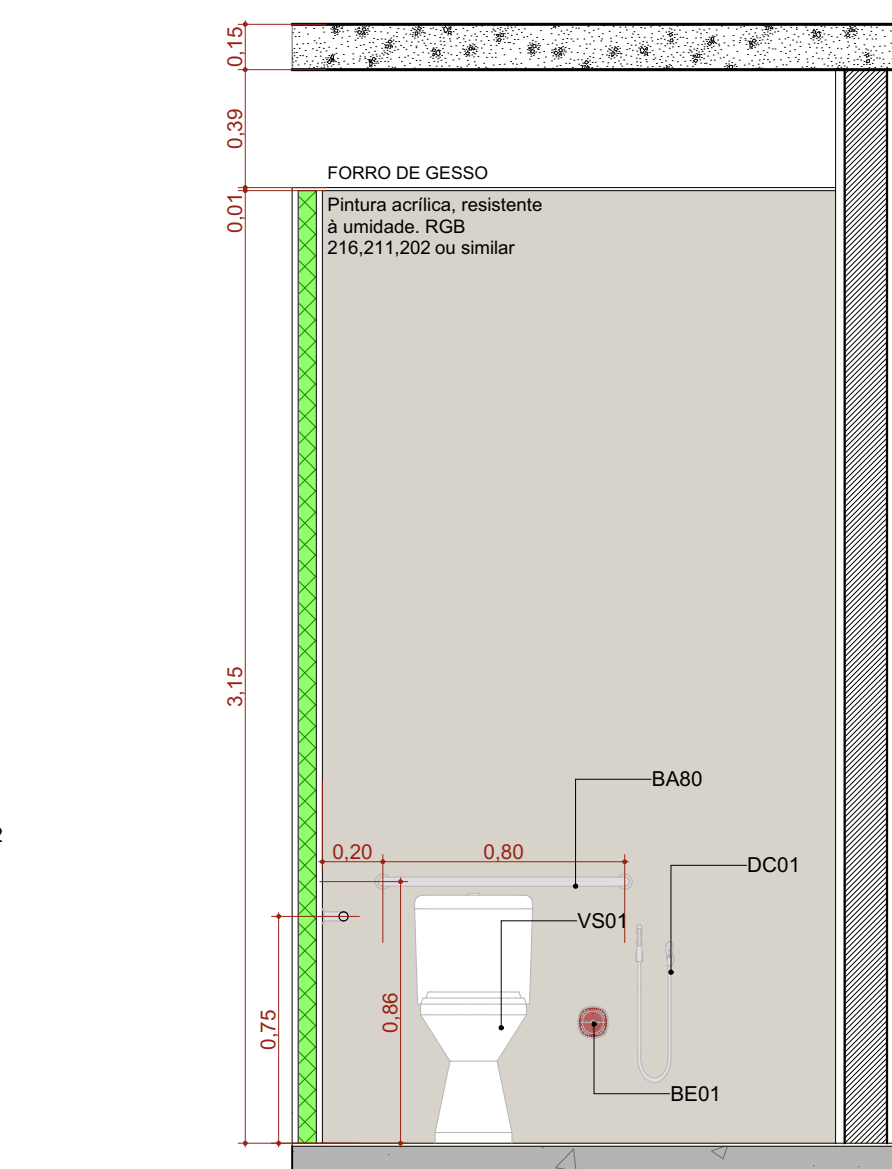

A.M.03 VISTA 02
Escala: 1:25

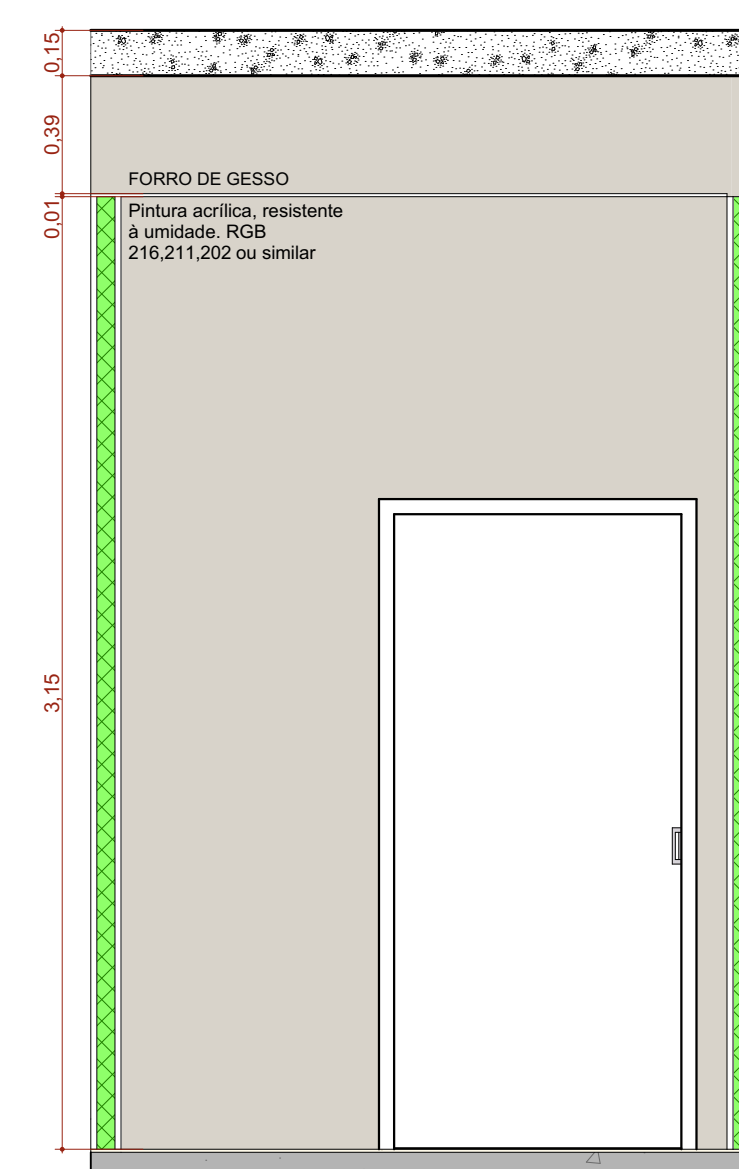

A.M.03 VISTA 03
Escala: 1:25

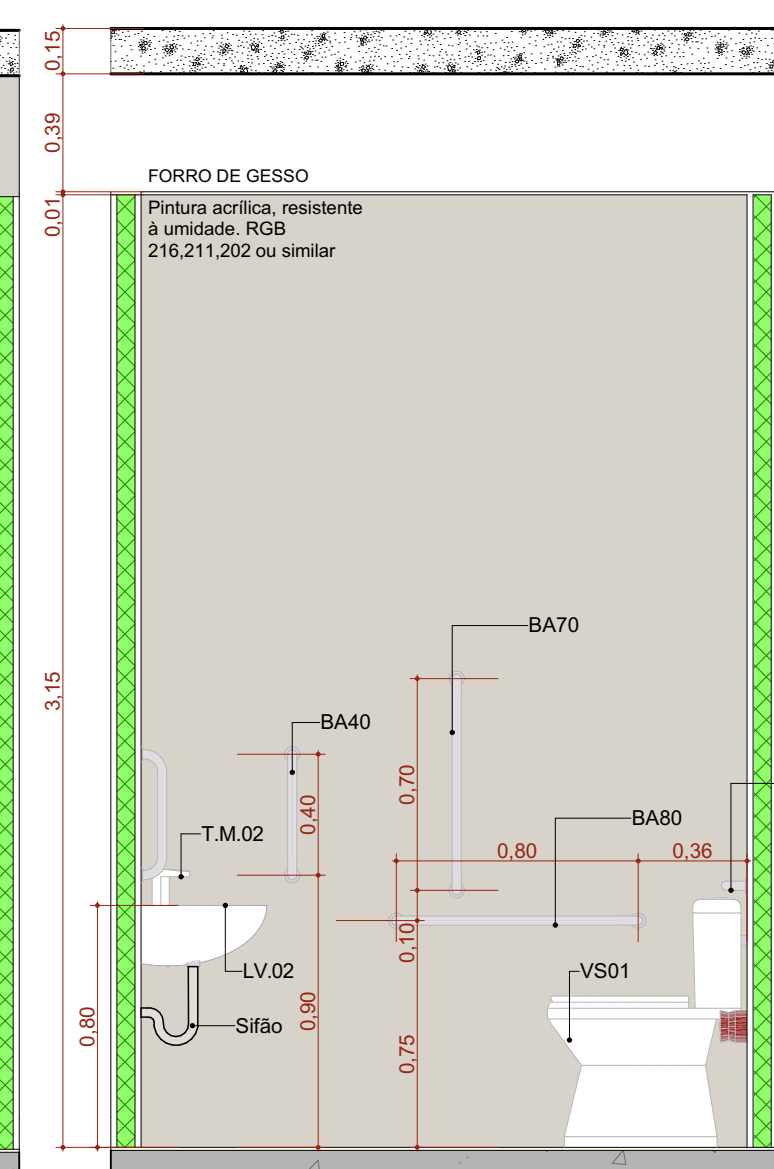

A.M.03 VISTA 04
Escala: 1:25

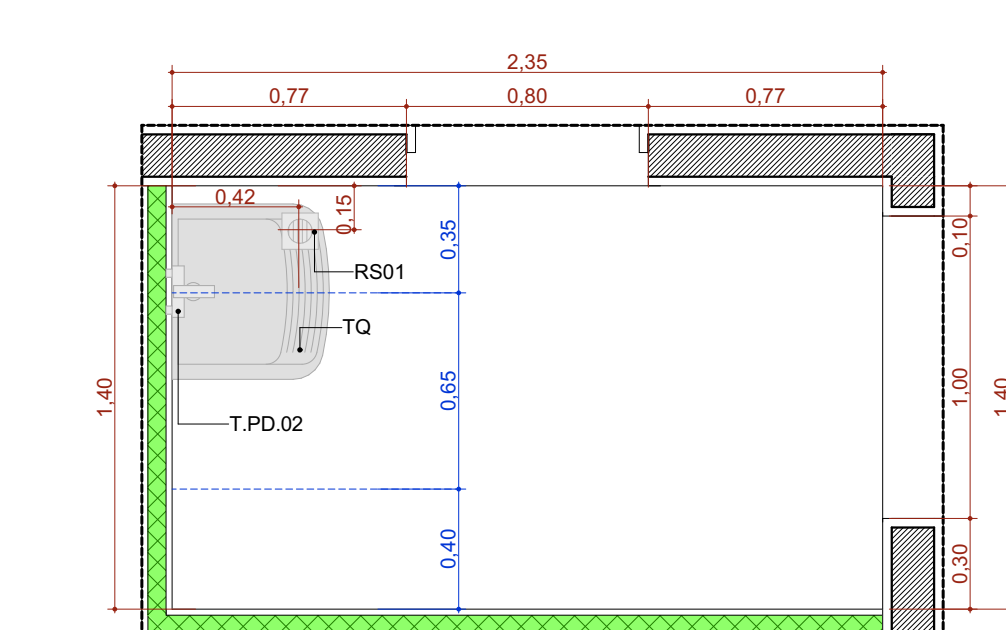

A.M.04 DML
Escala: 1:25

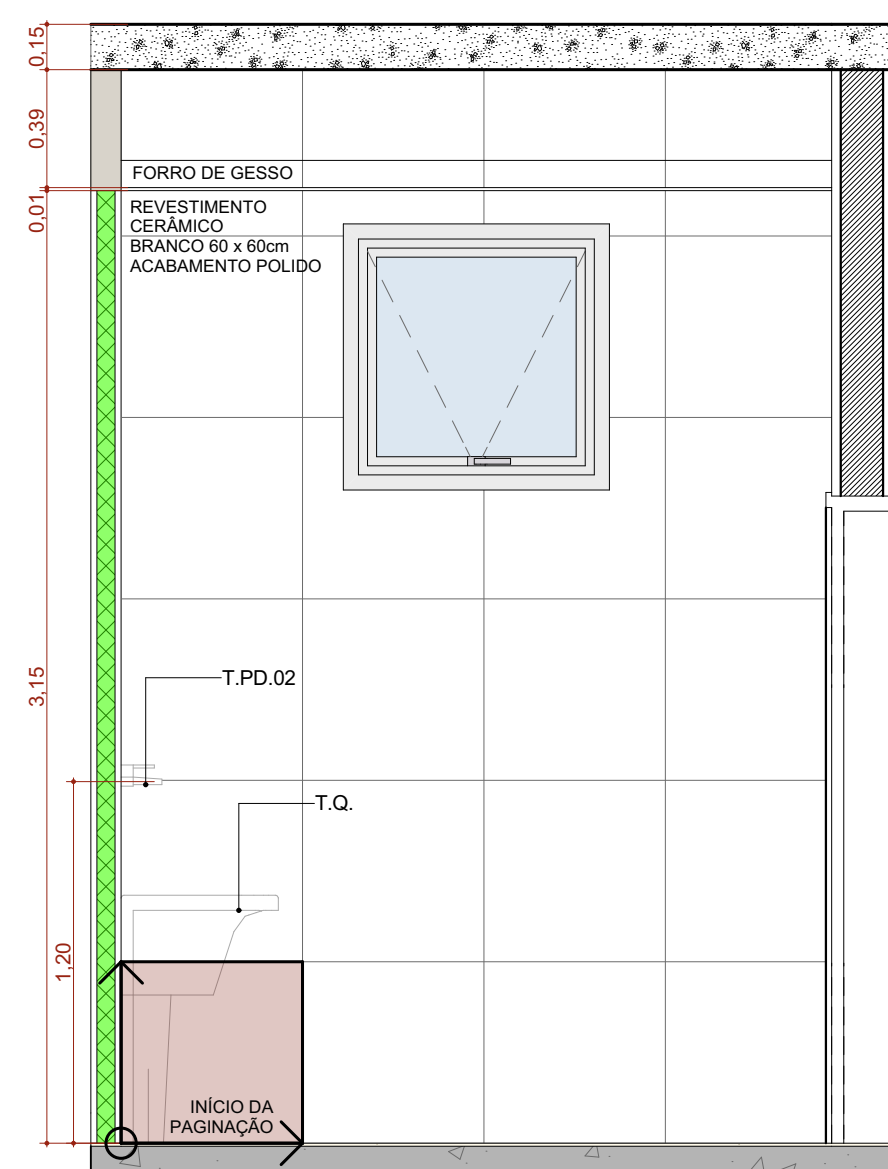

A.M.04 VISTA 01
Escala: 1:25

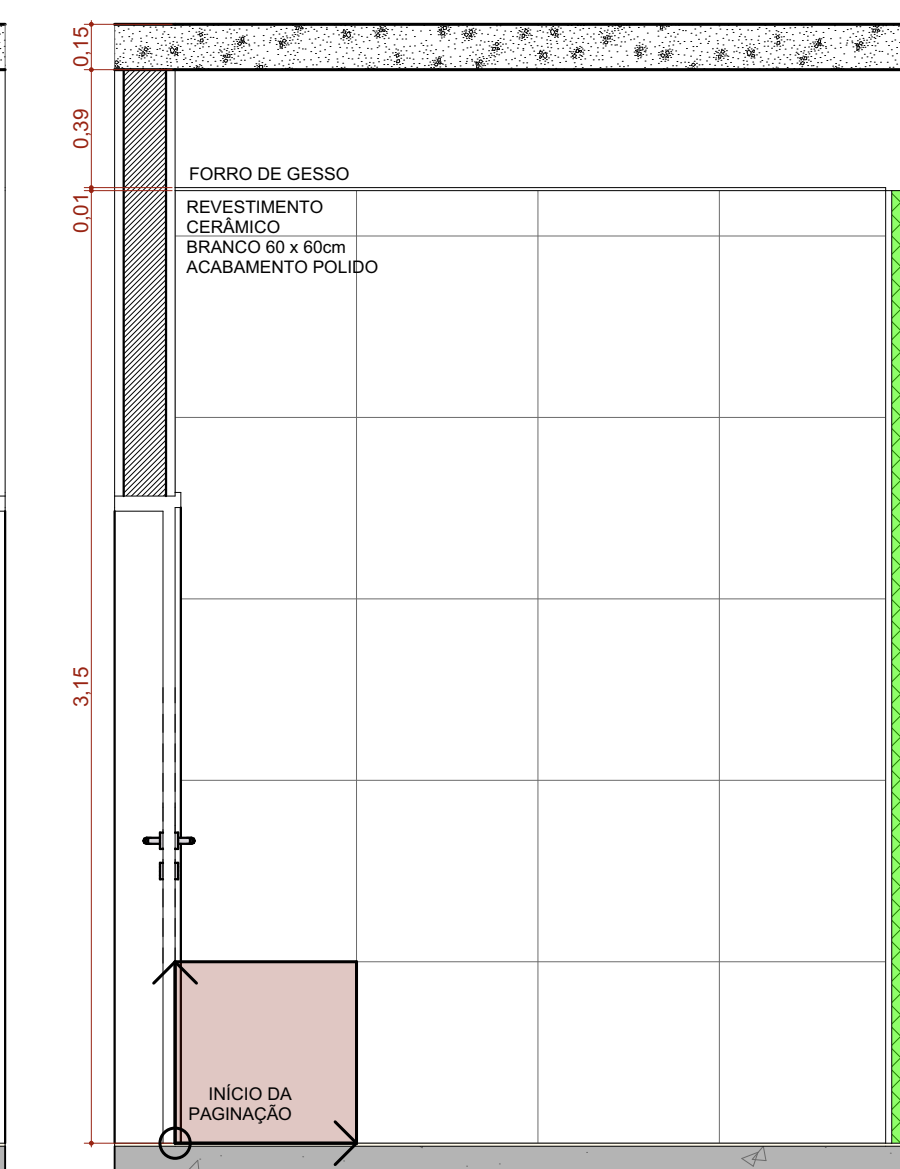

A.M.04 VISTA 02
Escala: 1:25

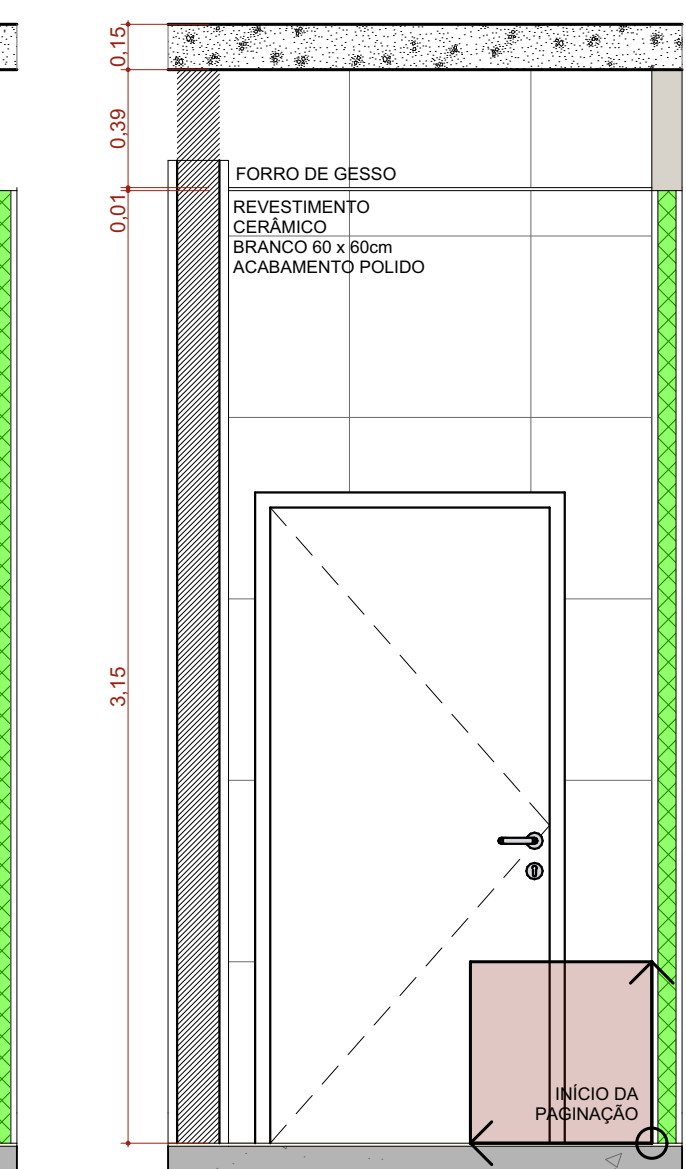

A.M.04 VISTA 03
Escala: 1:25

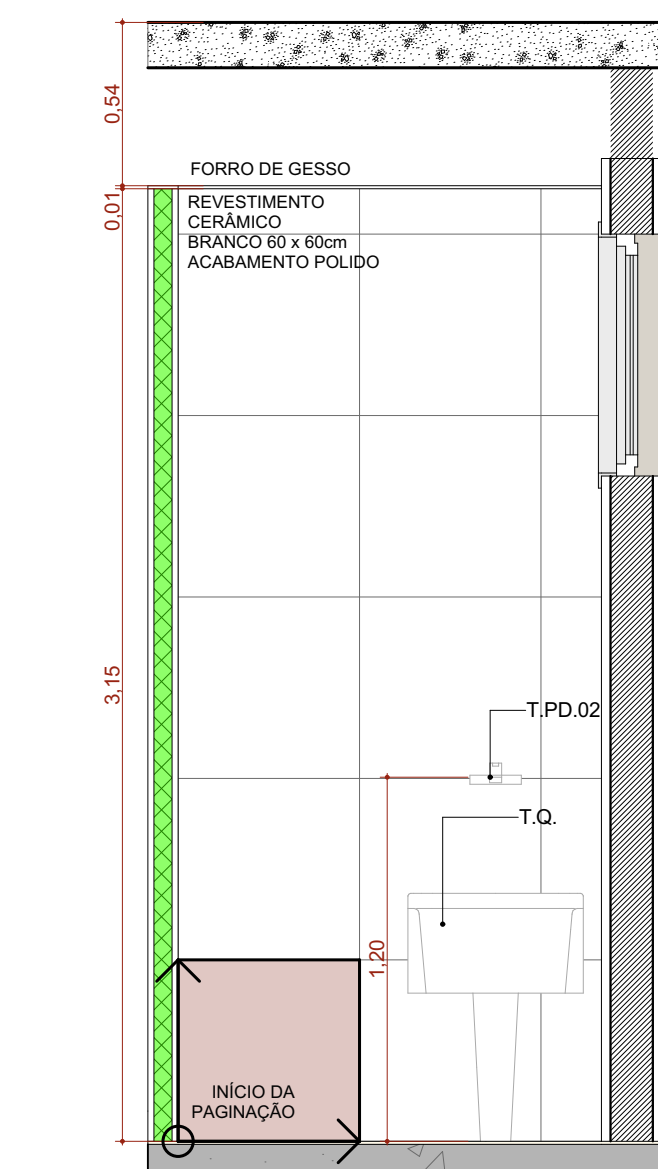

A.M.04 VISTA 04
Escala: 1:25

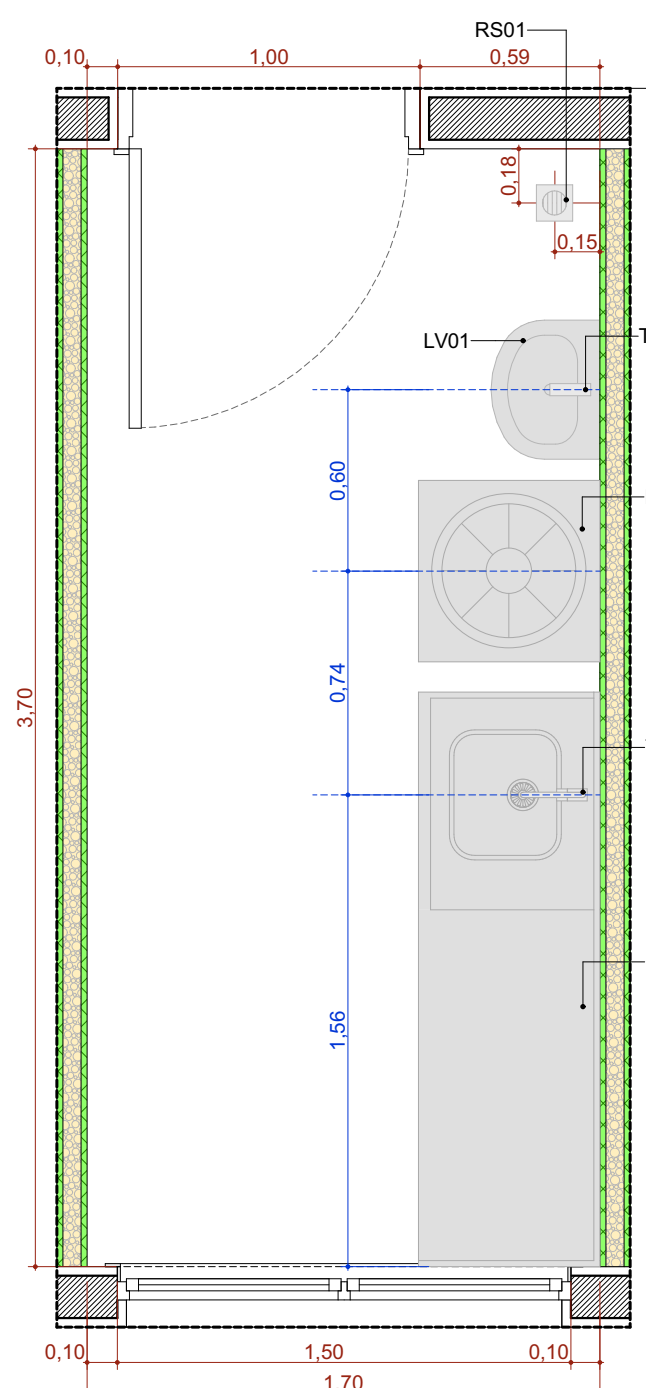

A.M.05 Utilidades
Escala: 1:25

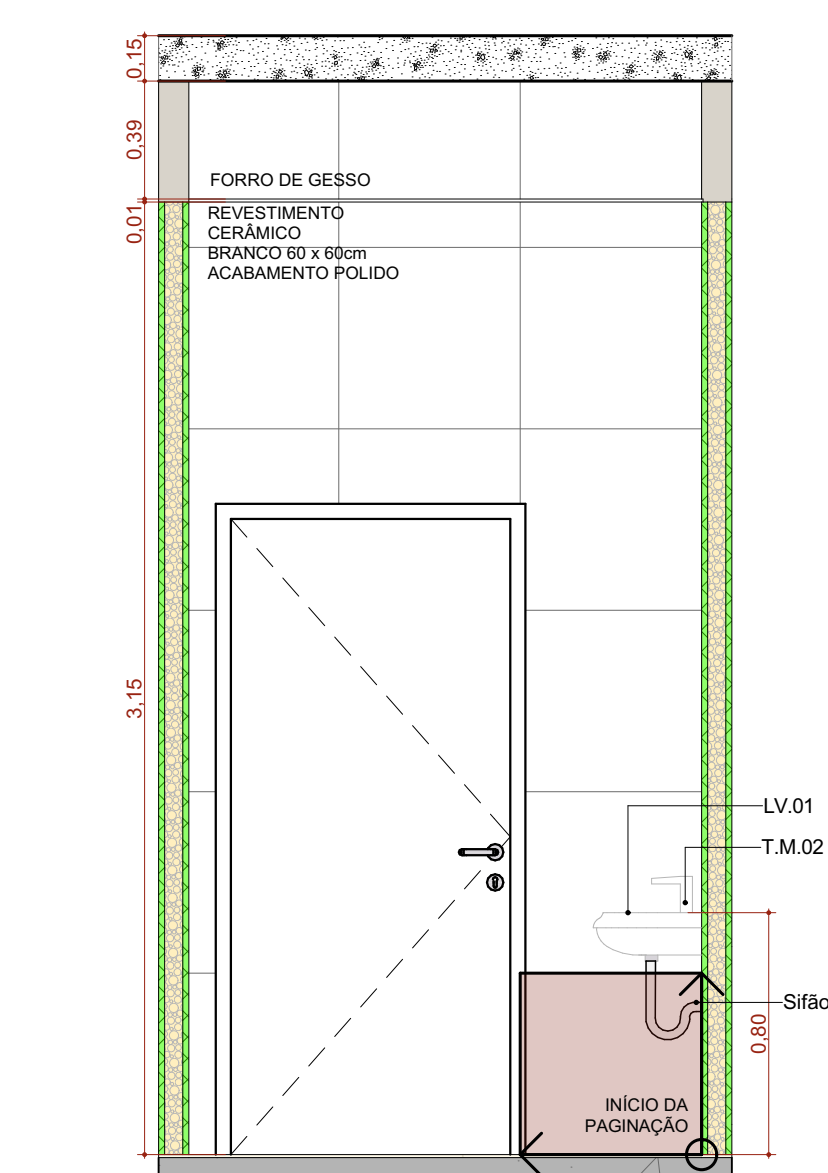

A.M.05 VISTA 01
Escala: 1:25

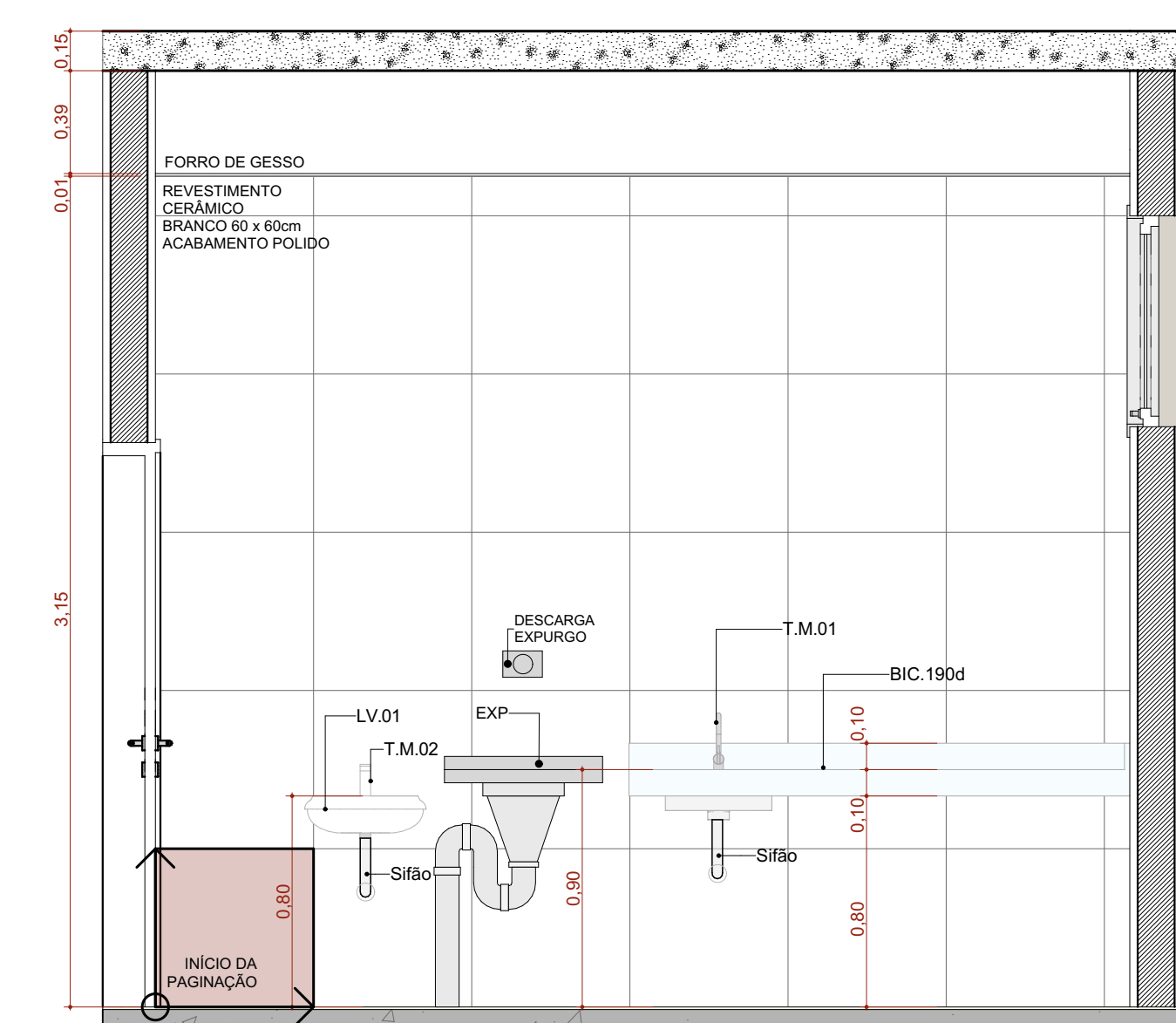

A.M.05 VISTA 02
Escala: 1:25

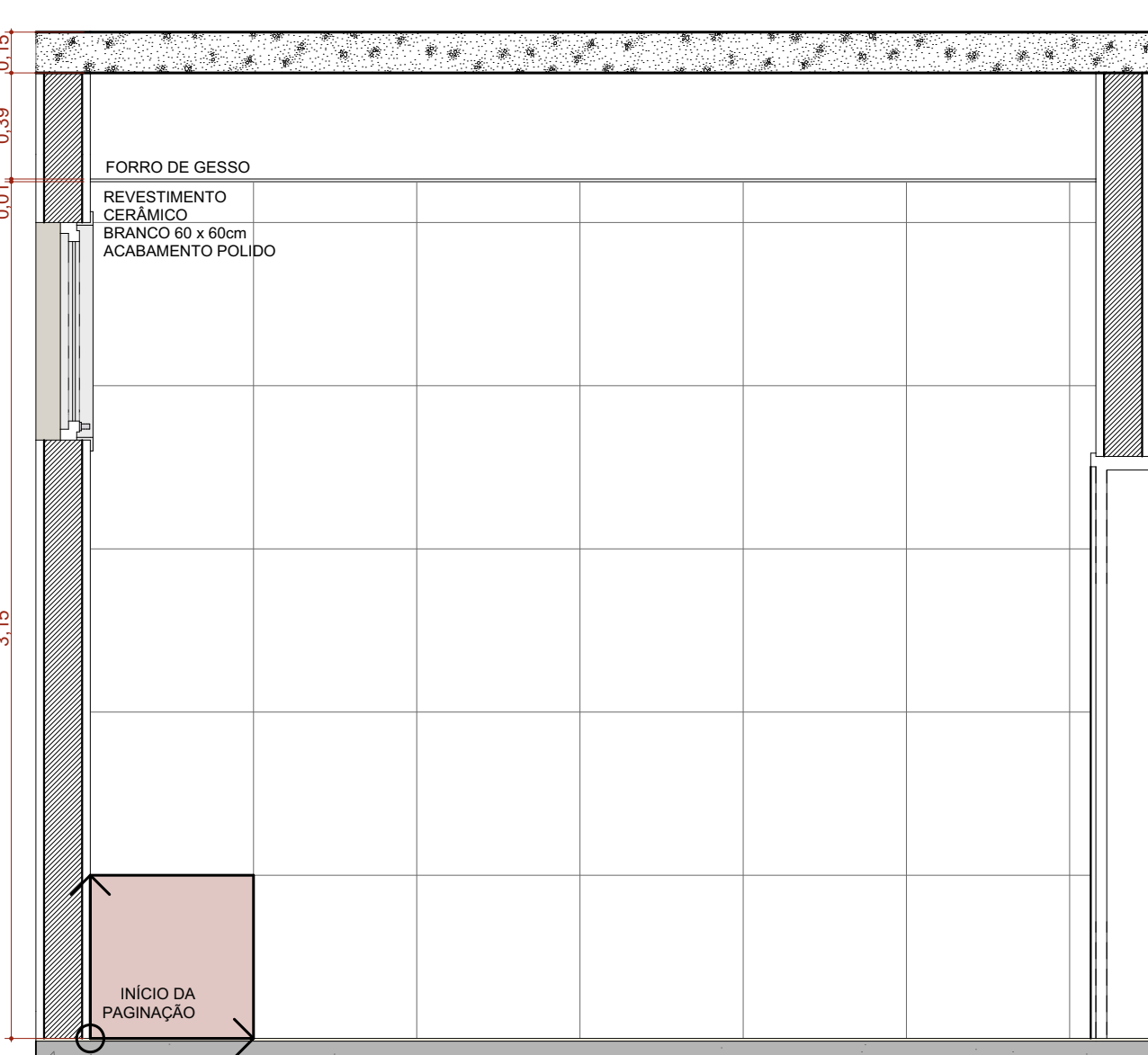

A.M.05 VISTA 03
Escala: 1:25

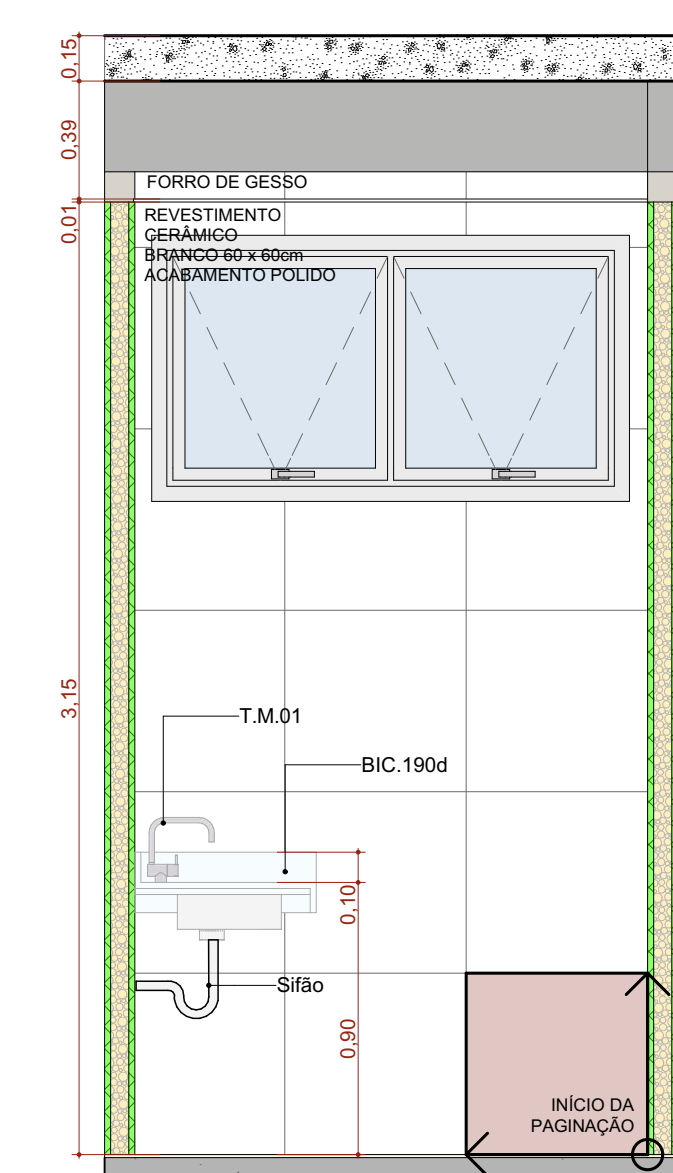

A.M.05 VISTA 04
Escala: 1:25

ASSINATURAS E CARIMBOS DO ENTE - APROVAÇÃO E EXECUÇÃO				PLANTA CHAVE DE SITUAÇÃO
R01	09/05/2025	PADRONIZAÇÃO DAS ESQUADRIAS		
R00	17/04/2025	EMIÇÃO INICIAL		
REVISÃO	DATA	EMIÇÃO INICIAL	DESCRIÇÃO	
TÍTULO DO PROJETO				
CENTRO DE ATENÇÃO PSICOSSOCIAL I e II				
PROPRIETÁRIO				
MINISTÉRIO DA SAÚDE				
SECRETARIA DE ATENÇÃO ESPECIALIZADA À SAÚDE				
CNPJ				
00.394.544/0109-03				
ENDEREÇO				
Esplanada dos Ministérios Bloco G Edifício Sede - Ministério da Saúde				
CEP 70. 058-900 - Brasília- DF				
TÍTULO DO PROJETO				
DETALHAMENTO ÁREAS MOLHADAS 01				
DESCRIÇÃO DA TÍTULO				
PROJETO REFERENCIAL CONCEITUAL				
NOVO PROJETO - PROJETO	REVISÃO	UNIDADE	DATA	ESCALA
R01	09/05/2025	METROS	09/05/2025	INDICADA
MIRELA PILÓN VESGATTI			A 25668-2	
VICTÓRIA ANGELI CAPOVILLA			A 247156-6	
LEONARDO MENDONÇA PEREIRA DOS SANTOS			A 186776-6	
DANIEL NARDELLI SANTOS			A 52345-9	
AUTORIA INTELLECTUAL			REDESENHO	
DIREITOS AUTORAIS RESERVADOS CONFORME LEGISLAÇÃO NACIONAL E INTERNACIONAL				